



**ZIP SYSTEM® WALL SHEATHING WITH BRICK VENEER AND ZIP SYSTEM® ROOF SHEATHING WITH TILE ROOF COVERING AT EAVE**

**07F**

**ROOF ASSEMBLY**

- CLAY/CONCRETE TIL ROOF
- ROOF UNDERLAYMENT (FOLLOW APPLICABLE CODE REQUIREMENTS FOR INSTALLATION)
- ZIP SYSTEM® ROOF SHEATHING\*
- ROOF TRUSS

ZIP SYSTEM® TAPE (INSTALLED OVER ALL JOINTS IN ZIP SYSTEM® ROOF SHEATHING)

1/8-INCH GAP RECOMMENDED AT PANEL EDGES UNLESS OTHERWISE PROVIDED BY MACHINED PROFILED EDGES

ROOF UNDERLAYMENT (SECOND LAYER OF A TWO-LAYER UNDERLAYMENT SYSTEM, INSTALLED IN ACCORDANCE WITH LOCAL BUILDING STANDARDS)

ICE DAM PROTECTION AS PRESCRIBED BY LOCAL BUILDING CODE.

SOFFIT VENT

**WALL ASSEMBLY**

- BRICK VENEER
- AIR SPACE (AS PRESCRIBED BY LOCAL BUILDING CODE)
- ZIP SYSTEM® WALL SHEATHING
- WOOD OR LT. GA. METAL STUDS

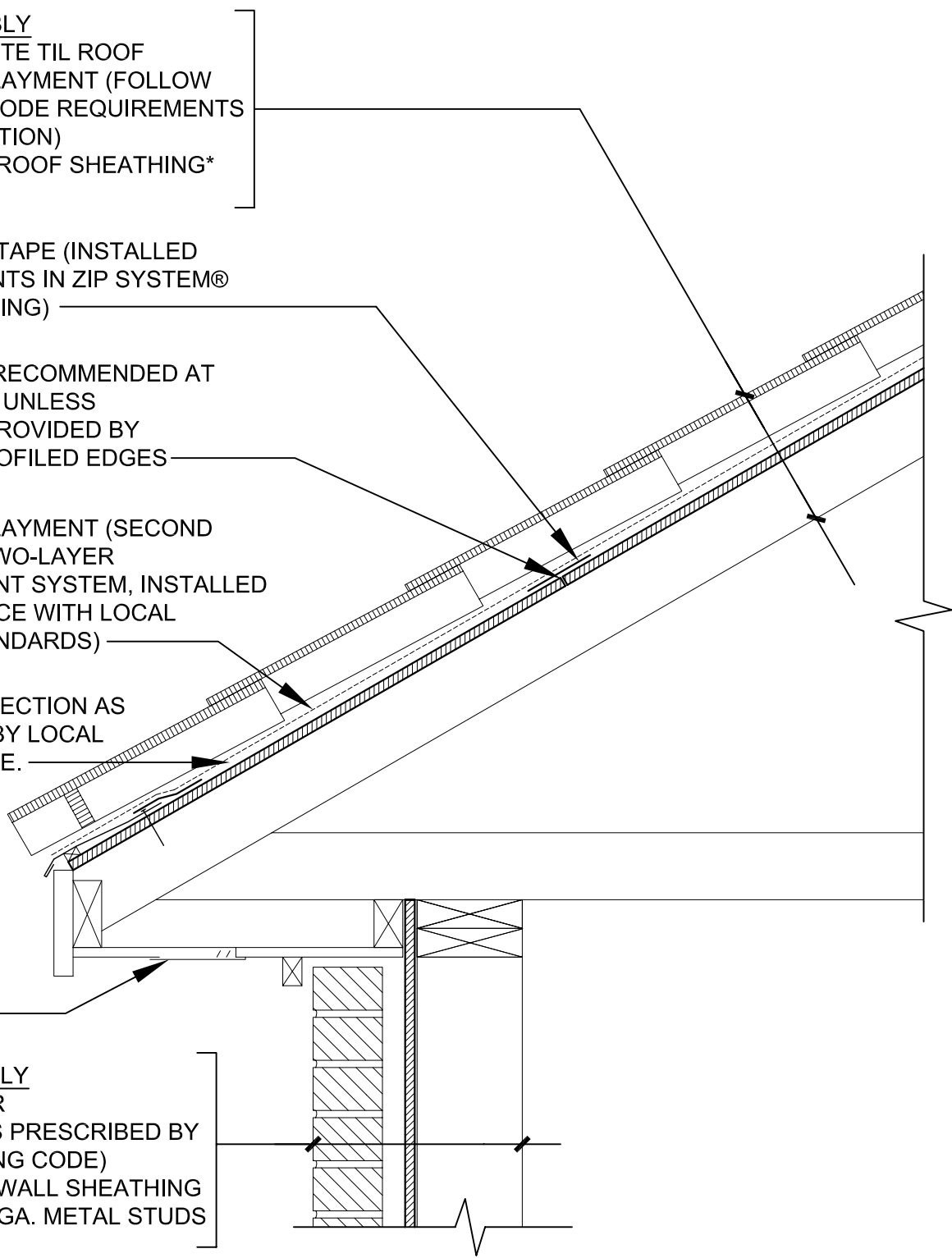

\*ZIP SYSTEM® ROOF SHEATHING IS APPROVED TO REPLACE THE FIRST LAYER OF A TWO-LAYER UNDERLAYMENT SYSTEM

**DRAWING NOT TO SCALE**

12-14-2007

Sales Office: 10925 David Taylor Drive - Suite 300 - Charlotte, NC 28262  
 Telephone: 800.933.9220 - Facsimile: 704.547.9228 - www.huberwood.com

*another innovation from*



**ENGINEERED WOODS**

These construction details are provided to assist in the installation of ZIP System® product(s) and may not apply to every situation. Manufacturer accepts no responsibility or liability for the use of these or other construction details.